

1 CORTE AA
ESCALA 1/75

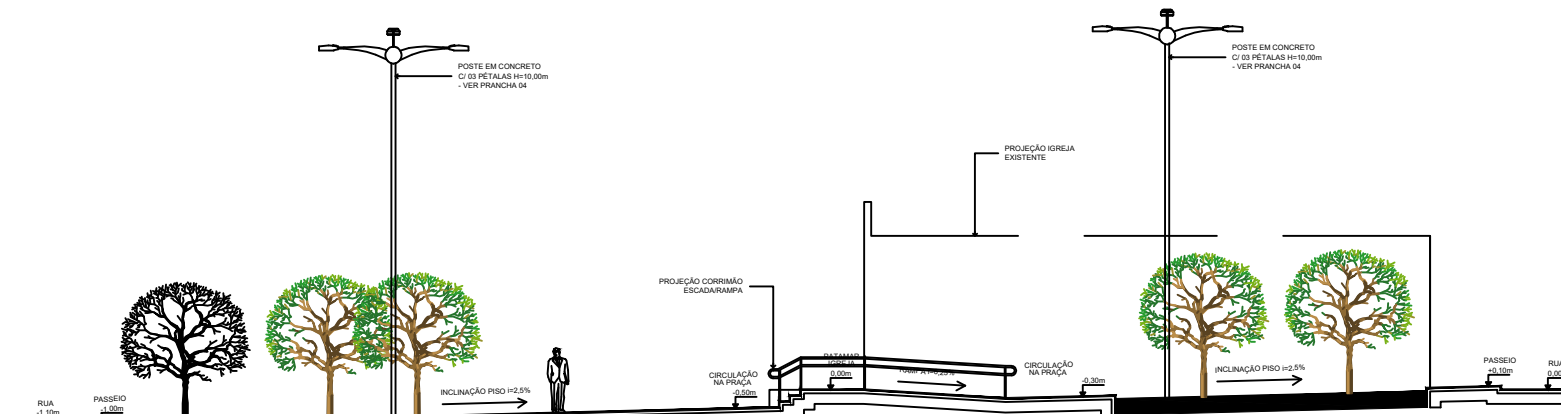

2 CORTE BB
ESCALA 1/75

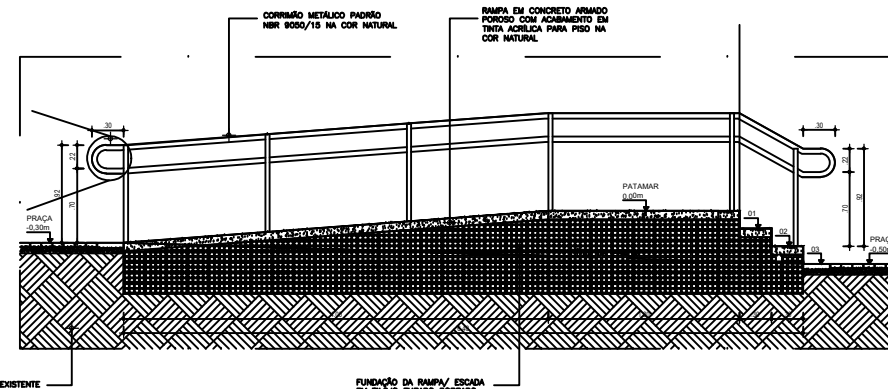
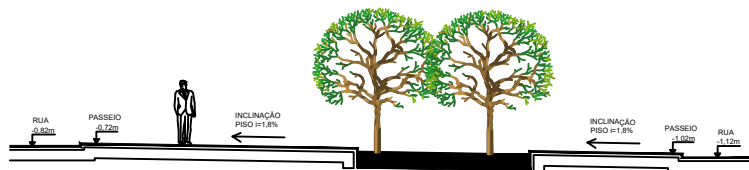

5 DETALHAMENTO RAMPA / ESCADA - CORTE AA
ESCALA 1/25

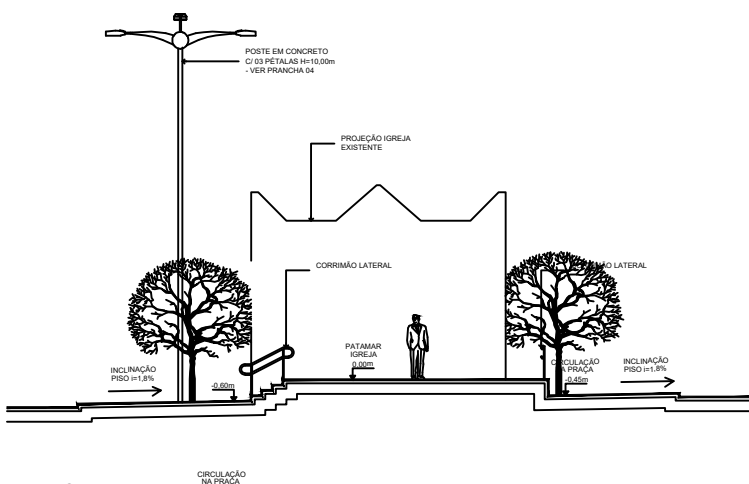

3 CORTE CC
ESCALA 1/75

4 DETALHAMENTO RAMPA / ESCADA - PLANTA
ESCALA 1/50

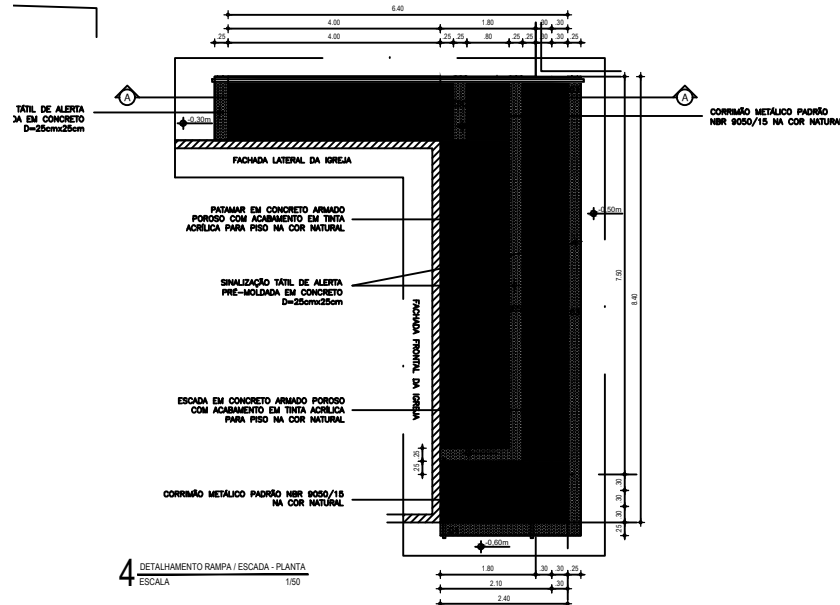

SECRETARIA DA INFRAESTRUTURA	
PROJETO: PROJETO ARQUITETÔNICO PRAÇA IGREJA ÁGUAS MORTAS	
INTERESSADO: PREFEITURA DE SOBRAL	AUTOR: PAULO VALE
ENDEREÇO: ASSENTAMENTO ÁGUA MORTA - LAT.: -4,124058 - LONG.: -39,796952	CO-AUTOR: GUILHERME AUSTREGESILIO
MUNICÍPIO: SOBRAL	
DATA: SETEMBRO/2019	REVISÃO: 01
ARQUIVO:	ARQ: 03/04

01 02 03 04 05 06 07 08 09 10 11 12 13 14 15 16 17 18 19 20 21 22 23 24 25 26 27 28 29 30 31 32 33 34 35 36 37 38 39 40 41 42 43 44 45 46 47 48 49 50 51 52 53 54 55 56 57 58 59 60 61 62 63 64 65 66 67 68 69 70 71 72 73 74 75 76 77 78 79 80 81 82 83 84 85 86 87 88 89 90 91 92 93 94 95 96 97 98 99 100