

2 DETALHAMENTO LIXEIRA
ESCALA 1/25

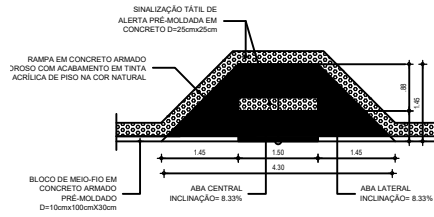

3 DETALHAMENTO RAMPA
ESCALA 1/25

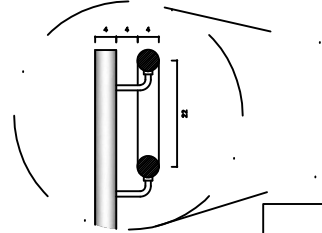
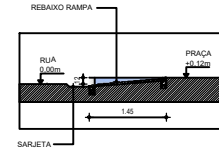

5 DETALHAMENTO RAMPA - CORTE AA
ESCALA 1/25

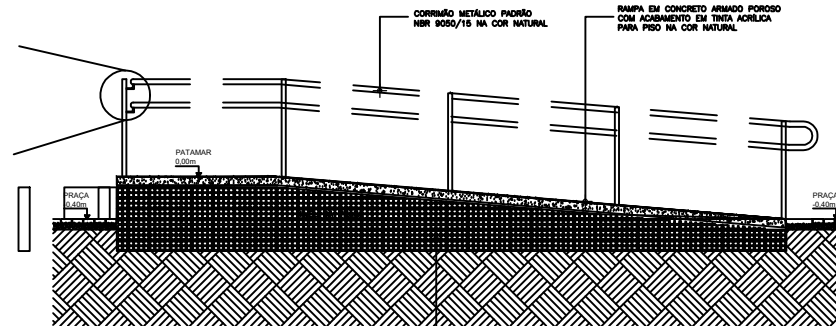

6 DETALHAMENTO POSTE
ESCALA 1/25

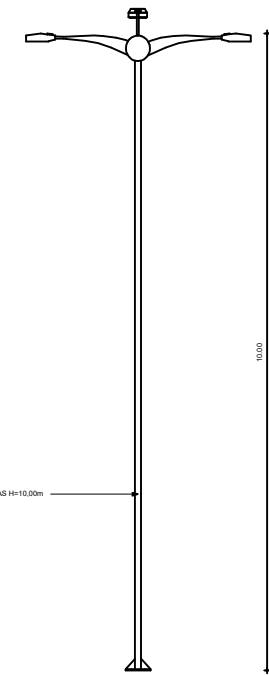

7 DETALHAMENTO LUMINÁRIA
ESCALA 1/25

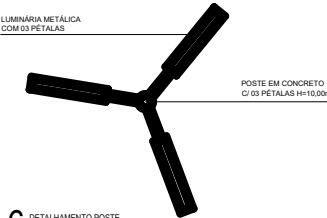

8 DETALHAMENTO POSTE
ESCALA 1/25

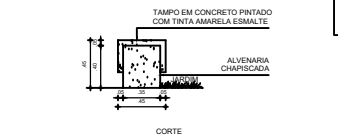

9 DETALHAMENTO CORTE



10 VISTA LATERAL

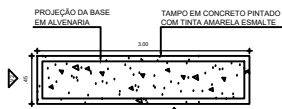

11 PLANTA BAIXA

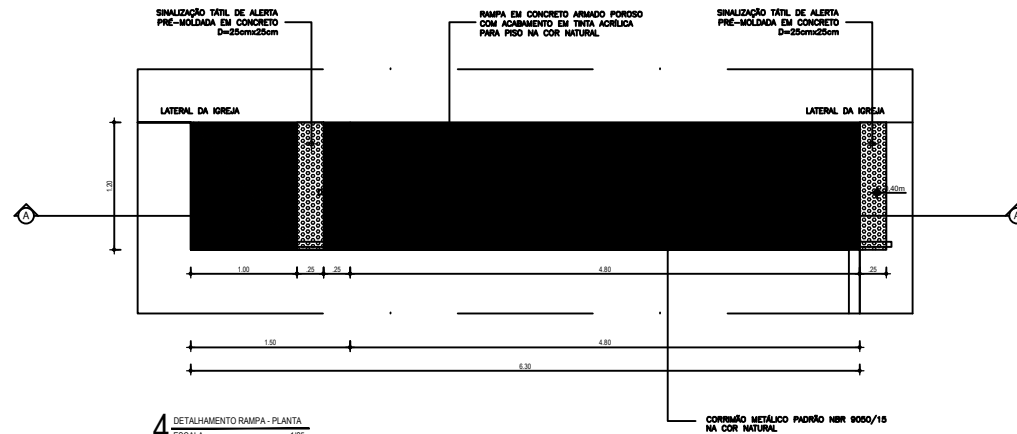

12 DETALHAMENTO RAMPA - PLANTA
ESCALA 1/25

LEGENDA

1 DETALHAMENTO BANCO
ESCALA 1/25

SECRETARIA DA INFRAESTRUTURA

PROJETO: PROJETO ARQUITETÔNICO PRAÇA IGREJA ÁGUAS MORTAS

INTERESSADO: PREFEITURA DE SOBRAL

INTERESSADO: PREFEITURA DE SOBRAL

ENDEREÇO: ASSENTAMENTO ÁGUA MORTA - LAT. - 4.124658 - LONG. - 39.796952

MUNICÍPIO: SOBRAL

AUTOR: PAULO VALE

CO-AUTOR: GUILHERME AUSTREGESILLO

PREFETURA DE SOBRAL

DATA: SETEMBRO/2019

REVISÃO: 01

ARQUIVO

ARG: 04/04